

### Kit Contents

1. Polycarbonate dust cover (ref. A)
2. Adjustable hole cutter mandrel with cutting blade mounting bar assembly (ref. B)
3. Spring (ref. C)
4. Wing nut (ref. D)
5. Ø10mm pilot drill (ref. E)
6. Ø8mm pilot drill for wood (ref. H)
7. 4 piece tungsten carbide tipped cutting blades (ref. F)
8. Hexagon key wrench
9. 5 piece Heat treated carbon steel wood drills (Ø4, 5, 6, 8, 10mm)
10. 5 piece tungsten carbide tipped masonry drills (Ø4, 5, 6, 8, 10mm)
11. 3 metre tape measure
12. Carpenters pencil

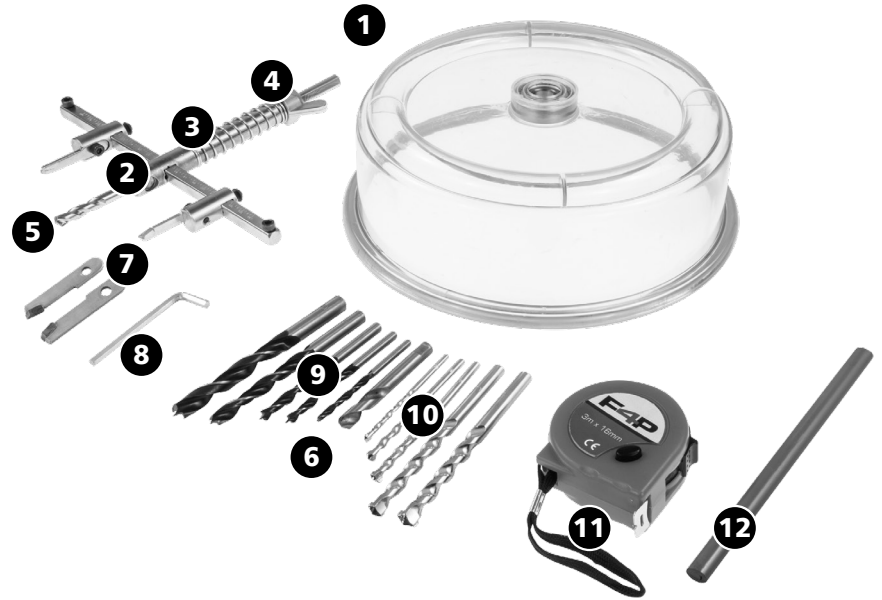

### Tool Assembly

- Select appropriate pilot drill (ref. E or H) and pair of cutting blades (ref. F) and assemble as shown in the diagram making sure the cutting blades are correctly orientated, tighten screws firmly.
- Adjust both cutting tool holders into the correct position to suit the diameter of hole required using the scale on the mounting bar for guidance. Fully tighten clamping screws when in the correct position.
- Remove wing nut (ref. D) and spring (ref. C) and assemble polycarbonate dust cover to the cutter assembly, then re-attach the spring and wing nut.

### Operating Instructions

- The multi size hole cutter can be used in most hand operated and pillar drilling machines, if using a hand operated machine check that the hammer action is switched off.
- Ensure that the cutter is perpendicular to the work piece and that the rotation speed is low, e.g. a 200mm diameter hole requires a speed of approximately 500 - 900rpm.
- Only apply light pressure against the material, especially at the beginning of the cut. Once the pilot drill has passed through the work piece the dust cover will bear against the material surface and trap any flying debris. The spring loaded mandrel will allow the cutter to continue drilling whilst retaining dust from cutting. Slow the cutter speed when near to break through and stop the rotation of the cutter before removing from the hole. Additional hole depth can be achieved by drilling from both sides of the material, if practical.

### Applications

This tool has a heavy duty mandrel and cutting blade mounting bar with two cutting tools for reduced tool load and vibration in use.

The hole diameter to be cut is infinitely variable within the tool operating range and is easily set using the integrated measuring scale.

The kit includes pilot drills and cutting blades for various materials and can be used on plywood, plasterboard, plastic sheets, ceiling tiles, brass and aluminium.

### Caution

- Ensure power is isolated before fitting or adjusting the tool
- Cutting blades are very sharp, take care and keep hands away when operating
- Do not use the tool without the polycarbonate cover.
- Do not start the drill away from the work piece
- Wear protective clothing, in particular for hands and eyes when operating the tool
- Ensure all screws are fully tightened before operating the tool

# INSTALLATION GUIDE



1. Adjust the distance between the two blades to match the required hole size to be cut.



2. Unlock and remove the spring and nut from the hole cutter.



3. Insert the cutter into the transparent cover.



4. Replace and tighten the spring and nut.



5. Cut hole by attaching a power drill to the top of the cutter.



6. The hole after cutting.