

Accessory

Developed for the quick fastening of cable tray to Gripple Universal Brackets, Fast Trak and G Brackets.

## FEATURES / BENEFITS

- **Secure** – Prevents uplift and slide of cable tray
- **Versatile** – Two sizes available to fit 2 mm and 3 mm thick steel
- **Easy** – tool-free, quarter turn installation
- **Quick** – push fit fixing saves time on the install, when compared to traditional methods



## INSTALLATION

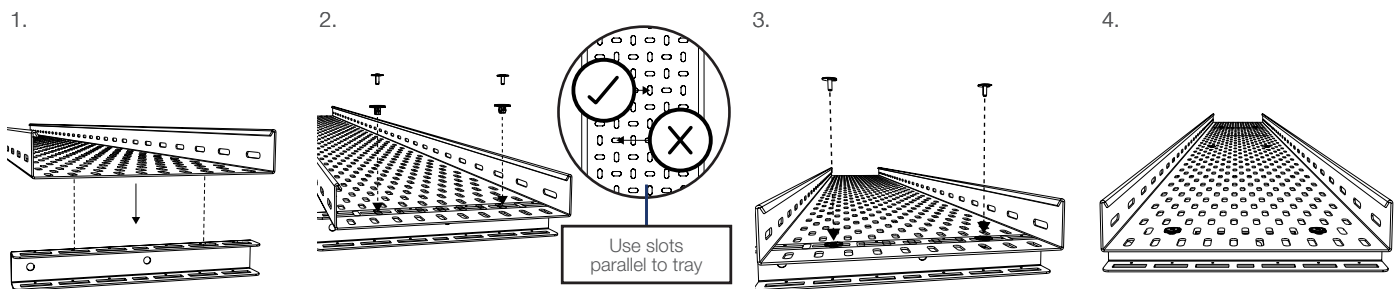

## SPECIFICATION

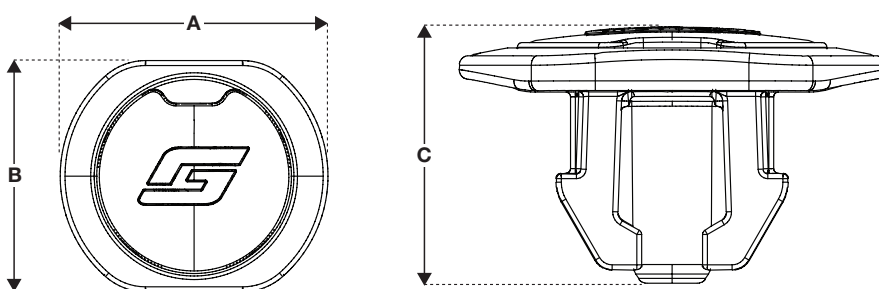

GREY (2 mm steel thickness)		
A (mm)	B (mm)	C (mm)
22	19	13

BLACK (3 mm steel thickness)		
A (mm)	B (mm)	C (mm)
22	19	13

## RELATED PRODUCTS

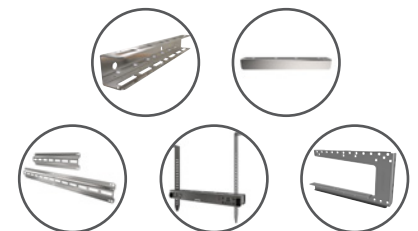

For more options on related products please contact us or visit [www.gripple.com](http://www.gripple.com)

## SUBMITTAL INFORMATION

**Safe Working Load:**  
Non load bearing.

**Material:**  
Acetal Copolymer (POM C) (ERCACETAL C)

**Colour**  
Grey - 2 mm steel thickness  
Black - 3 mm steel thickness